



INSTALLATION, OPERATION, & MAINTENANCE MANUAL



MD-1250 1,250 lb Motorcycle Dolly

⚠ FOLLOW THIS MANUAL CAREFULLY TO ENSURE THE PRODUCT WILL FUNCTION CORRECTLY AND PROVIDE MANY YEARS OF DEPENDABLE SERVICE. FAILURE TO FOLLOW THESE INSTRUCTIONS AND SAFETY WARNINGS MAY RESULT IN PERSONAL INJURY OR PROPERTY DAMAGE. USE OF STRAPS IS RECOMMENDED - SOLD SEPARATELY. KEEP THIS MANUAL IN A SAFE DRY PLACE FOR FUTURE REFERENCE.



TITAN MARKETING, LLC

PO Box 7069 Greenwood, IN 46142
1.888.908-4826 FAX (317) 215.2770
www.titanlifts.com

To Our Valued Customers:

Thank you for purchasing a Titan Lifts® product. We hope this high quality equipment provides you with years of dependable service.

It is unfortunate that rare situations may occur with the products you purchase from Titan Lifts®. We value your business as well as the trust you have and need to maintain your relationship with us. Titan Lifts® carries liability coverage that may protect our customers if a situation does occur. However, as in all accidents there must be proof of liability for a claim to be made. Our insurance company requires the following procedures be observed in order to consider a claim:

- A. The claimant must contact the Titan Lifts® distributor immediately with the facts of the situation.
- B. If any equipment is damaged, including vehicles or shop equipment, Titan Lifts® must be given the opportunity to send an impartial representative to the site for proper assessment of the situation.
- C. The Vehicle cannot be moved until either an impartial representative has reviewed the accident or clear and precise pictures are taken that reflect all the pertinent information for an impartial representative to be able to access the information from a distance. Titan Lifts® or its representatives must approve the pictures before anything can be moved.
- D. If any potential liability is determined on behalf of Titan Lifts®, two estimates must be submitted for damages to be reimbursed.

It is imperative that the claimant complies with these procedures, because without proper assessment of the situation a claim will be denied.

ARBITRATION NOTICE

The installation or use of this equipment shall constitute an acknowledgement that the user agrees to resolve any and all disputes or claims of any kind whatsoever, which relate in any way to the equipment, by way of binding arbitration, not litigation. No suit or legal action may be filed in any state or federal court. Any arbitration shall be governed by the Federal Arbitration Act, and administered by the American Mediation Association, Indianapolis Indiana. The maximum amount that an arbitrator may award and all damages shall not exceed the retail value of this equipment.

WARRANTY NOTICE

This equipment must be installed by a "Professional Installer" assembled and used in the manner according to the documentation provided to be covered by warranty.

Damaged or missing components must be reported within 72 hours of receipt to your freight carrier and to the distributor. Claims must be filed to cover cost.

If you have any questions or if we can be of any further assistance, please don't hesitate to contact a Titan Lifts® representative at 1-888-908-4826. Thank you for the opportunity to continue to serve your lift equipment needs.

INSTRUCTIONS

 **WARNING:** READ ENTIRE MANUAL AND COMPLY WITH ALL SAFETY AND SERVICE PRECAUTIONS. DEATH, PERSONAL INJURY AND / OR PROPERTY DAMAGE MAY OCCUR IF INSTRUCTIONS ARE NOT FOLLOWED CAREFULLY.

UNPACKING AND SET-UP *REFER TO PARTS LIST FIG. 1

1. Carefully unpack the dolly making sure that all of the parts have been included.
2. Make sure to use the dolly on a clean, smooth solid surface that is capable of sustaining the load.
3. Place both stopping ramps in the down position prior to loading.

ASSEMBLY

1. Attach the Caster Assembly (2) to Frame Assembly (1) and Side Kickstand Tray (17) by using Hex Bolt M6 (3), Washers (4), Lock Washers (5) and Nut M6 (6). Secure firmly.
2. Attach the Connecting Plate (7) to the two side of Stopping Ramp A (9). Then attach the Connecting Plate (7) to the Frame Assembly (1) by using the Cheese Head Bolt (8), Washers (4), Lock Washers (5) and Nut M6 (6). Repeat for Stopping Ramp B (18).
3. Connect the two Frame Assemblies (1) with the Connecting Pipes (16), then secure them by using Bolt M8 (11), Washer (12), Lock Washer (13) and Nut M8 (14).
4. Lastly, fit the Side Kickstand Tray (17) to the Frame Assembly (1) by using Bolt M8 (15) Washer (12), Lock Washer (13) and Nut M8 (14). Attach two Stop Pins (10) to the slots on each end of the Frame Assembly (1), Tighten all connecting points.

OPERATION & MAINTENANCE

1. All moving parts have been lubricated at the factory and should be re-lubricated before the first use and at least once every six months to prevent damage.
2. Do not use this product if worn or damaged. Examine dolly for structural cracks, bends, or other signs of damage prior to each use to ensure safe proper working condition.
3. Keep the dolly clean, dry, and well maintained to extend longevity of the product.
4. When not in use, the dolly must be stored in a dry location.

SAFETY PRECAUTIONS

1. Load should not exceed rated capacity for this dolly – 1250 lbs
2. Only trained people should operate the dolly.
3. Indoor use recommended.
4. Do not make any modifications to the dolly.
5. Keep hands, tools, and other extremities from any moving parts.
6. Maintain a safe working environment. The work area should be clean, dry, clutter free, and sufficiently lit.
7. Wear proper safety attire. Do not wear loose fitting clothing while operating. Long hair, sleeves and other loose articles should be secured.
8. Keep children and bystanders away from work area. Do not let children operate or play on dolly.
9. Do not use if under the influence of drugs or alcohol. Operator must be alert at all times.
10. Never use the dolly with someone on it.
11. This dolly is designed for carrying motorcycles. Do not use this product for an application for which it was not designated. Misuse can lead to personal injury and/or property damage.

PARTS LIST (FIG. 1)

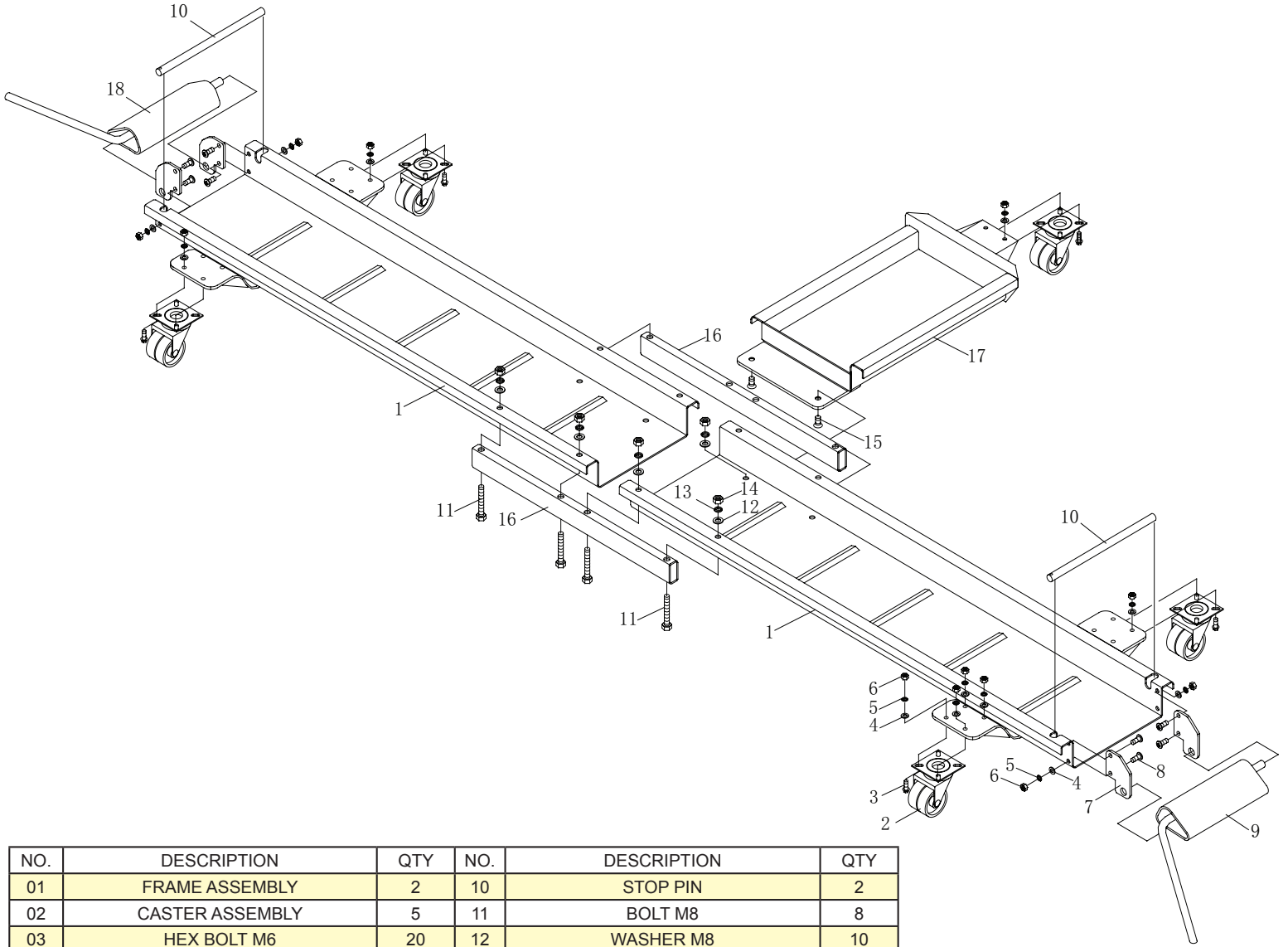

NO.	DESCRIPTION	QTY	NO.	DESCRIPTION	QTY
01	FRAME ASSEMBLY	2	10	STOP PIN	2
02	CASTER ASSEMBLY	5	11	BOLT M8	8
03	HEX BOLT M6	20	12	WASHER M8	10
04	WASHER M6	28	13	LOCK WASHER M8	10
05	LOCK WASHER M6	28	14	NUT M8	10
06	NUT M6	28	15	BOLT M8	2
07	CONNECTING PLATE	4	16	CONNECTION PIPE	2
08	PAN HEAD BOLT M6	8	17	SIDE KICKSTAND TRAY	1
09	STOPPING RAMP A	1	18	STOPPING RAMP B	1

WARNING

The warnings, precautions and instructions in this manual cannot cover all possible conditions and situations that may occur. The operator must understand that the operator must supply common sense and examine caution factors when using this product to determine safety in all circumstances being used.



TITAN MARKETING, LLC

PO Box 7069 Greenwood, IN 46142
1.888.908-4826 FAX (317) 215.2770

www.titanlifts.com

Copyright © 2014 by Titan Marketing, LLC. All rights reserved. No portion of this manual or any artwork contained herein may be reproduced in any shape or form without the express consent of Titan Marketing, LLC. Diagrams within this manual may not be drawn proportionally. Due to continuing improvements, actual product may differ slightly from the product described herein. Tools required for assembly and service may not be included.