



## INSTALLATION MANUAL



### **MODEL:**

**TC-450S-HA**

**Pneumatic Assist Arm for XL TOOL TC-450S**

**⚠ FOLLOW THIS MANUAL CAREFULLY TO ENSURE THE MACHINE WILL FUNCTION CORRECTLY AND PROVIDE MANY YEARS OF DEPENDABLE SERVICE. FAILURE TO FOLLOW THESE INSTRUCTIONS AND SAFETY WARNINGS MAY RESULT IN PERSONAL INJURY OR PROPERTY DAMAGE. KEEP THIS MANUAL IN A SAFE DRY PLACE FOR FUTURE REFERENCE.**

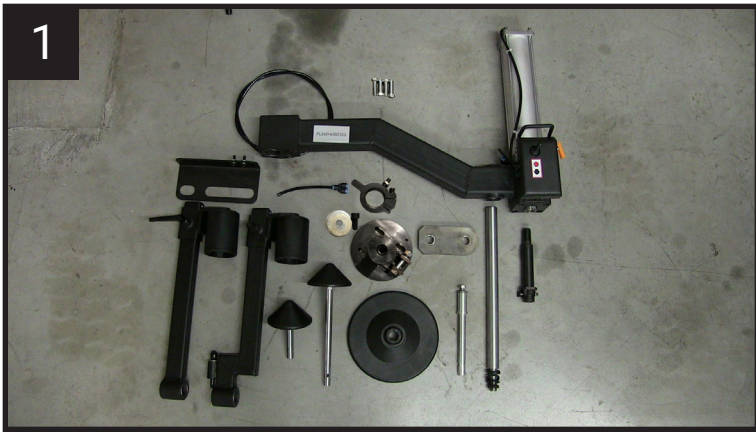

1  
 Upon receiving the item, remove all contents from the crate, inspect for any damage, and verify that all components are present.  
 \*Titan Lifts must be notified within 72 hours if any components are damaged or missing.

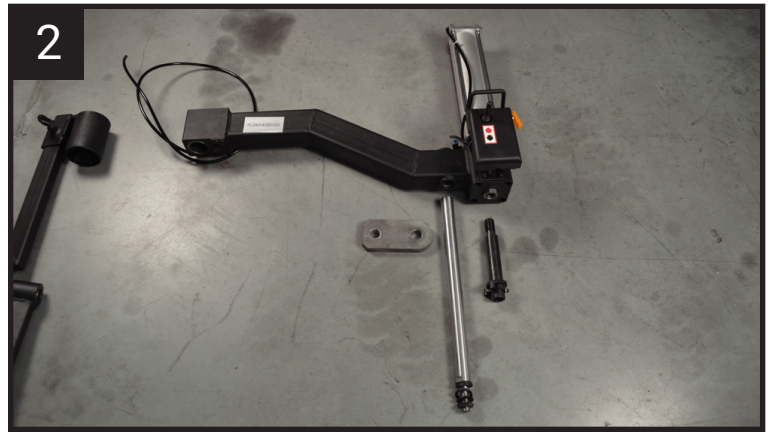

2  
 •Remove Fixture Shaft(#2) from the cylinder.  
 •Remove Guide Plate(#4) from Upper Guide Post(#3).  
 \*Take note of washer and bushing placement when removing nut from guide post.  
 •Remove Upper Guide Post(#3) from Assist Arm Assembly(#1).



3  
 •Attach top plate assembly(#7) using four hex bolts(#8).  
 \*Note the orientation of the top plate assembly(#7) in relation to the swing arm mount.

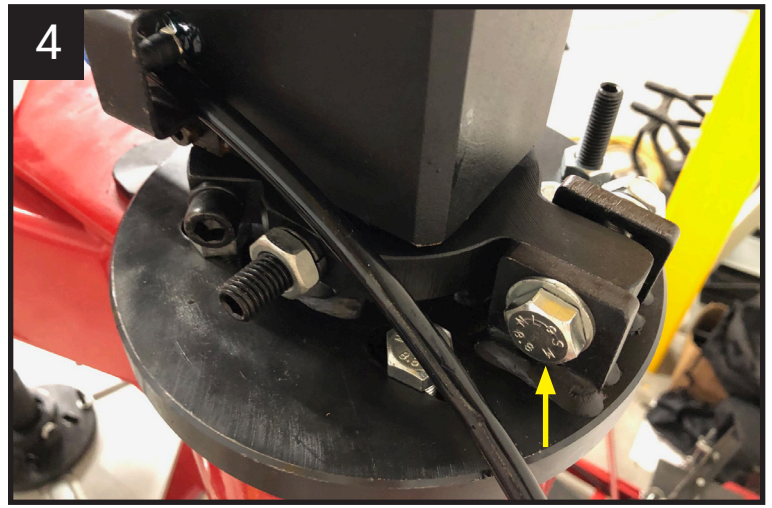

4  
 Thread hex bolt(#17) (hex head w/flat washer on one side, flat washer/lock washer/nut on the other side) through the bracket and threaded flange of the collar.



5  
 Place the assist arm assembly(#1) onto the mounting post of the top plate assembly(#7).

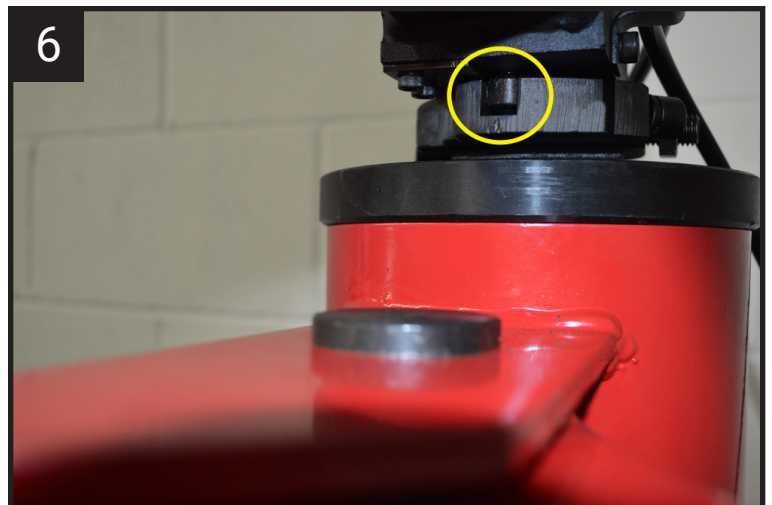

6  
 Adjust the assist arm assembly(#1) until the locking mechanism falls into the groove in the lock collar(#6).

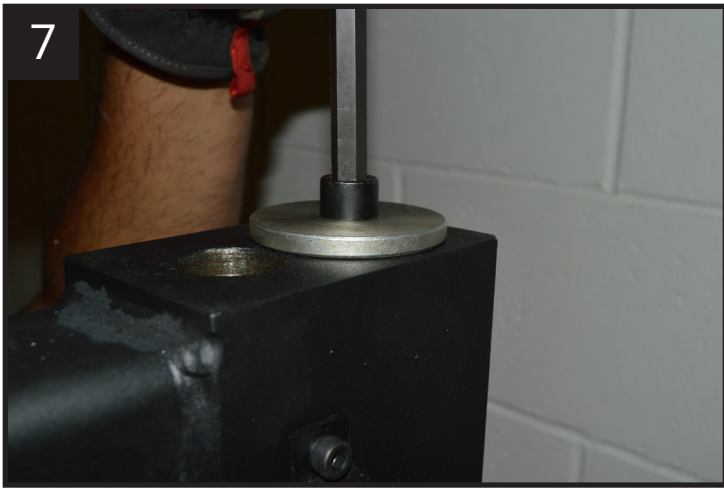

Tighten the bolt and large washer through the top of the assist arm assembly(#1).

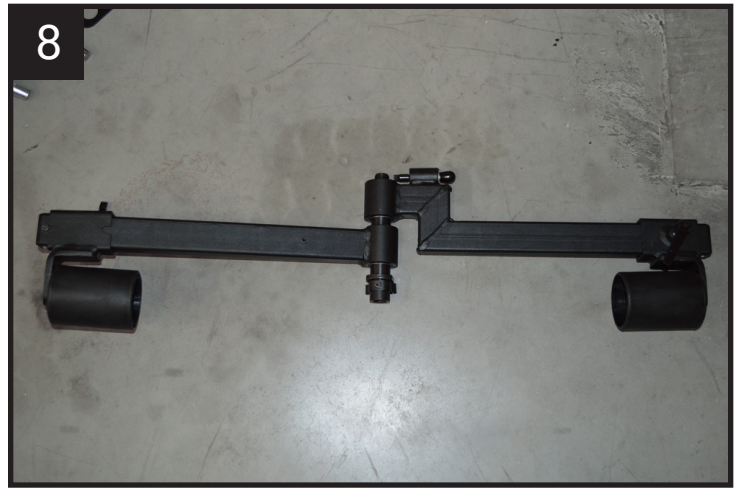

Place Rotation Arm A(#11) and Rotation Arm B(#12) onto Fixture Shaft(#2) as shown.

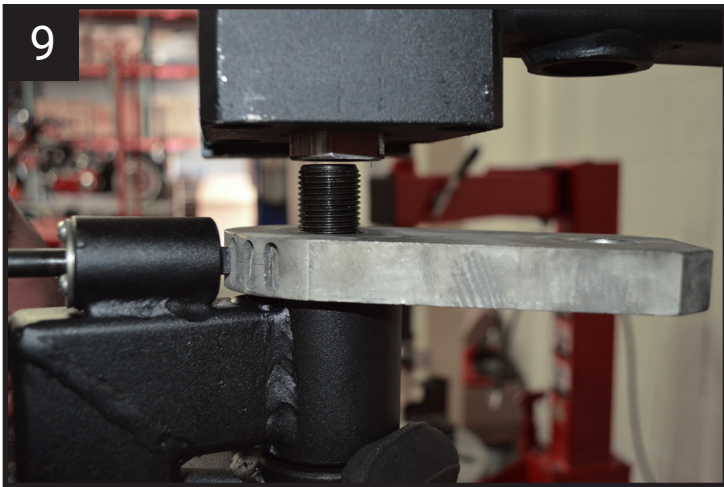

- Place Guide Plate(#4) on top of rotation arms on Fixture Shaft(#2).
- \*Note placement of the notches in the Guide Plate(#4).
- Use spring loaded pin on Rotation Arm B(#12) to help hold the Guide Plate(#4) in position and tighten the Fixture Shaft(#2) into cylinder.



- Install Upper Guide Post(#3) through the Assist Arm Assembly(#1) and Guide Plate(#4).
- \*Be sure to properly install the washers and bushings on each side of the Guide Plate(#4).
- Tighten nut on bottom of Upper Guide Post(#3).

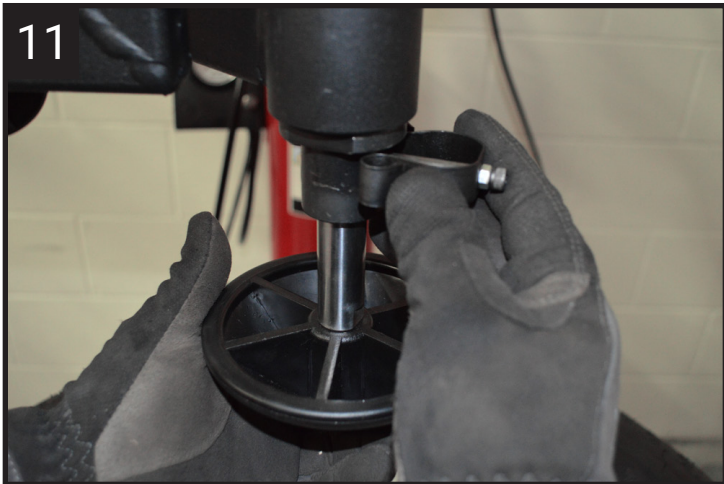

Install either Small(#13) or Large(#14) Centering Cone into Fixture Shaft(#2).



Mount Switch Panel(#5) to Assist Arm Assembly(#1) using supplied 5mm bolts.



13

Connect airline from Switch Panel(#5) to cylinder fitting.



14

Attach Accessory Bracket(#10) to backside of TC-450S machine using supplied 6mm bolts.



15

Connect Airline Y Fitting(#9) to airlines on TC-450S machine.



16

Press toggle switch on the Switch Panel(#5) down until the Centering Cone(#13/14) meets the center hub of the wheel.

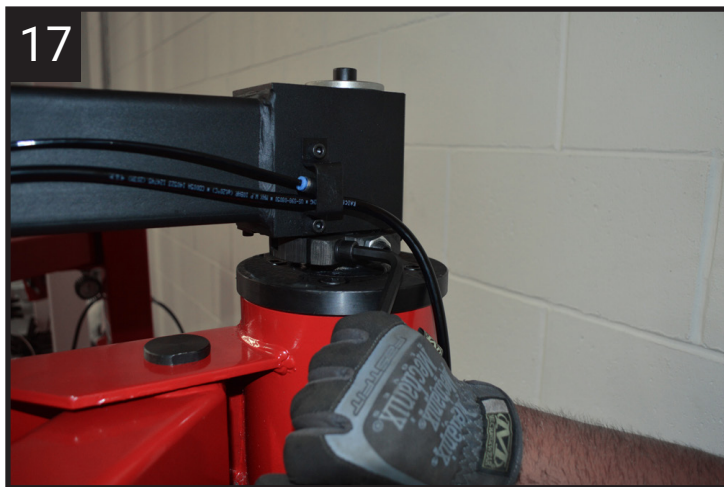

17

Tighten the front 8mm bolt to clamp the Lock Collar(#6) to the mounting post of the Top Plate Assembly(#7).



18

Tighten the two 8mm studs on the Lock Collar(#6), then tighten the jam nuts.  
\*These last two steps ensure that the pneumatic lock built into the Assist Arm Assembly(#1) will engage when the arm is centered over the wheel.

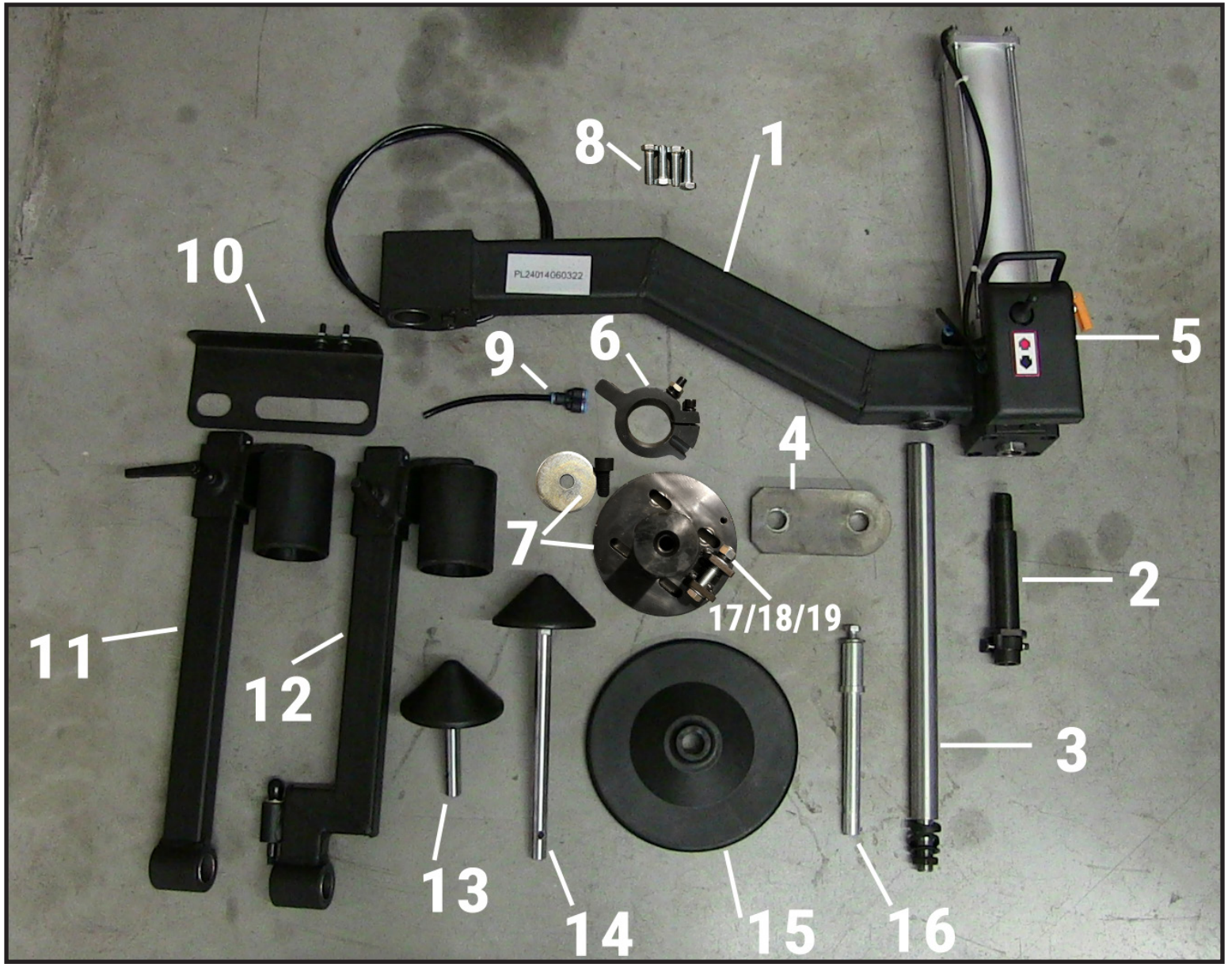

Part #	Description	Quantity	Part #	Description	Quantity
1	Assist Arm Assembly	1	11	Rotation Arm A	1
2	Fixture Shaft	1	12	Rotation Arm B	1
3	Upper Guide Post	1	13	Small Centering Cone	1
4	Guide Plate	1	14	Large Centering Cone	1
5	Switch Panel	1	15	Round Plate	1
6	Lock Collar	1	16	Round Plate Mounting Shaft	1
7	Top Plate Assembly	1	17	Hex Bolt	1
8	Hex Bolt	4	18	Flat Washer	2
9	Airline Y Fitting	1	19	Lock Washer	1
10	Accessory Bracket	1			

# WARRANTY REGISTRATION

In order to utilize the warranty on this Titan Lifts product, you must register your product with us. The simplest way to do this is to visit [TITANLIFTS.COM/WARRANTIES](https://www.titanlifts.com/warranties) and submit your information online. If you prefer to send your information through the mail, please fill out the form below and send this page to us at :

**Titan Lifts  
PO Box 7069  
Greenwood, IN 46142**

EQUIPMENT MODEL: \_\_\_\_\_ SERIAL NUMBER: \_\_\_\_\_  
TYPE OF POWER UNIT: \_\_\_\_\_ SERIAL NUMBER: \_\_\_\_\_  
DATE OF PURCHASE: \_\_\_\_\_  
PLACE PURCHASED: \_\_\_\_\_  
NAME: \_\_\_\_\_  
STREET: \_\_\_\_\_  
CITY, STATE, ZIP: \_\_\_\_\_  
PHONE: \_\_\_\_\_  
EMAIL: \_\_\_\_\_

OPT OUT OF PROMOTIONS



In order to receive your warranty, return this card or visit [TITANLIFTS.COM/WARRANTIES](https://www.titanlifts.com/warranties) within 30 days.





## **WARNING**



The warnings, precautions and instructions in this manual cannot cover all possible conditions and situations that may occur. The operator must understand that the operator must supply common sense and examine caution factors when using this product to determine safety in all circumstances being used.



**TITAN MARKETING, LLC**

PO Box 7069 Greenwood, IN 46142  
1.888.908-4826 FAX (317) 215.2770  
[www.titanlifts.com](http://www.titanlifts.com)

Copyright © 2020 by Titan Marketing, LLC. All rights reserved. No portion of this manual or any artwork contained herein may be reproduced in any shape or form without the express consent of Titan Marketing, LLC. Diagrams within this manual may not be drawn proportionally. Due to continuing improvements, actual product may differ slightly from the product described herein. Tools required for assembly and service may not be included.